



## Walm Lane, NW2

£3,000 Per Month

AVAILABLE TO LET is this bright and airy three bedroom flat, offering 1023 sq ft of well laid out accommodation, set on the Top Floor of this handsome, red brick style building situated within the highly sought after Mapesbury Conservation Area.

- Spacious Top Floor Flat
- Offering 1023 sq ft of accommodation
- 3 bedrooms & 1 bathroom
- Stylish kitchen & bright reception
- Set in the heart of the Mapesbury Dell
- Transport: Willesden Green (Jubilee - Zone 2)
- Deposit: £3,461
- COUNCIL: Brent (E)
- Early viewing is highly recommended



020 8450 9377 - 020 8459 1133  
[rentals@cameronsstiff.co.uk](mailto:rentals@cameronsstiff.co.uk)

## Walm Lane, NW2

Approx Gross Internal Area = 95.1 sq m / 1023 sq ft  
For identification only - Not to scale

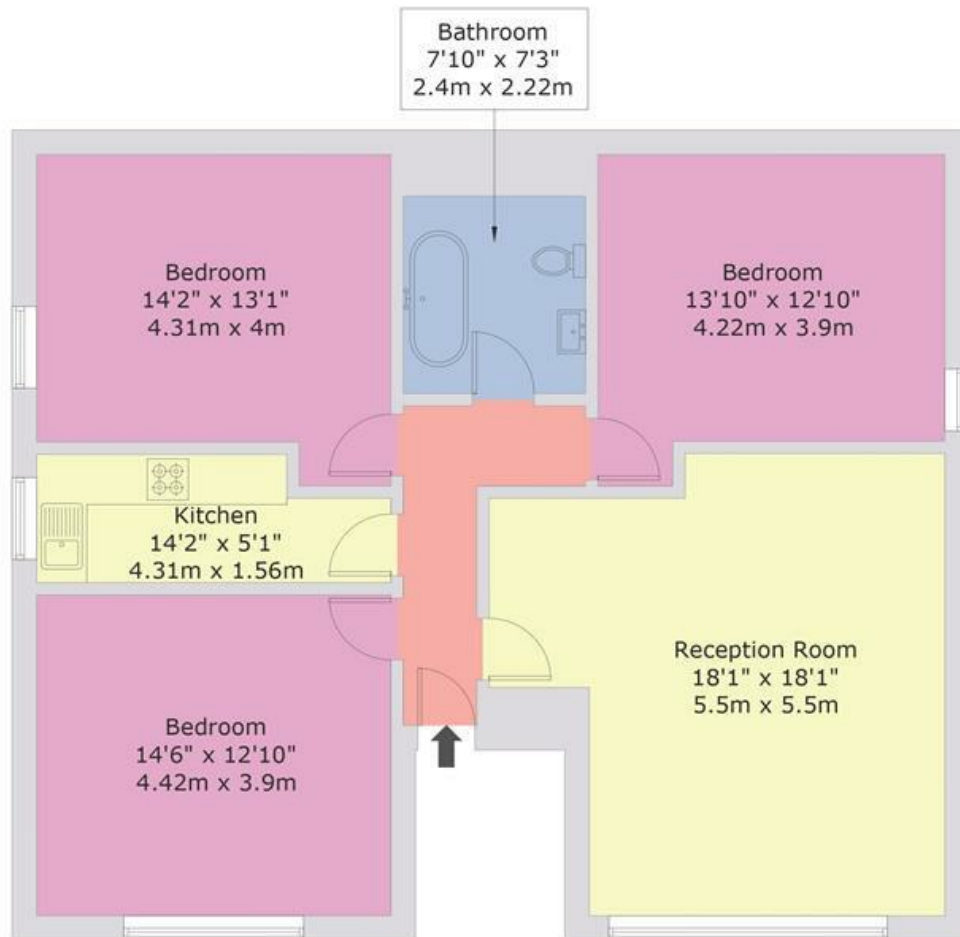

### SECOND FLOOR



This floor plan is produced in accordance with RICS Property Measurement Standards incorporating International Property Measurement Standards (IPMS2 Residential). Maximum lengths and widths are represented on the floor plan. Produced for Cameron Stiff & Co. Copyright © BLEUPLAN

EPC: D

Ref: 15820547

